

# SelecTone® Audible Signaling Device

Model 50GCB



## CEILING MOUNT 4" SPEAKER/AMPLIFIER

- Attractive round ceiling grille
- Appropriate for office environments
- Available in 24VAC/24VDC and 120VAC
- Built in gain control
- Produces 64dB to 88dB @ 10' (74dB to 98dB @ 1m)
- UL Listed, CSA Certified
- NEMA 1, IP41 enclosure

The SelecTone® Model 50GCB round ceiling speaker/amplifier is capable of reproducing crisp, clear tone signals and highly intelligible voice messages. This SelecTone unit features a four-inch speaker fronted by a seven-inch white grille.

The Model 50GCB operates on 24VAC/DC or 120VAC power, and can be used as a stand-alone audible device. By plugging in the Model UTM (Universal Tone Module), one of 18 tones can be produced by the 50GCB. When multiple tones or public address is desired, the 50GCB can be part of a system controlled by models 300VSC-1, 300VSC-1044SB, 300SCW-1 or 300SSC. This versatile speaker/amplifier can also be used with the 300MB and/or 300MC CommCenter™ Digital Message Centers, and can be added to an existing centrally amplified system with the AM25CK, AM70CK or AM100CK connector kits.

Internal gain control allows tone output adjustment from 64dB to a maximum of 88dB at ten feet (74dB to 98dB at 1m).

The Model 50GCB is designed for low ambient noise level areas, such as office spaces, hallways and lobbies. The 50GCB's baffle allows the four inch speaker to be easily mounted in any suspended ceiling plenum (with model R4NB backbox). The white grille is compatible with most decors.

Model	Voltage	Operating Current	Sys. Standby Current	Decibels @ 10'	1m
50GCB	24VDC	0.07 amps	0.025 amps	88	98
50GCB	24VAC 50/60Hz	0.22 amps	0.095 amps	88	98
50GCB	120VAC 50/60Hz	0.04 amps	0.027 amps	88	98



**SELECTONE® AUDIBLE SIGNALING DEVICE (50GCB)**

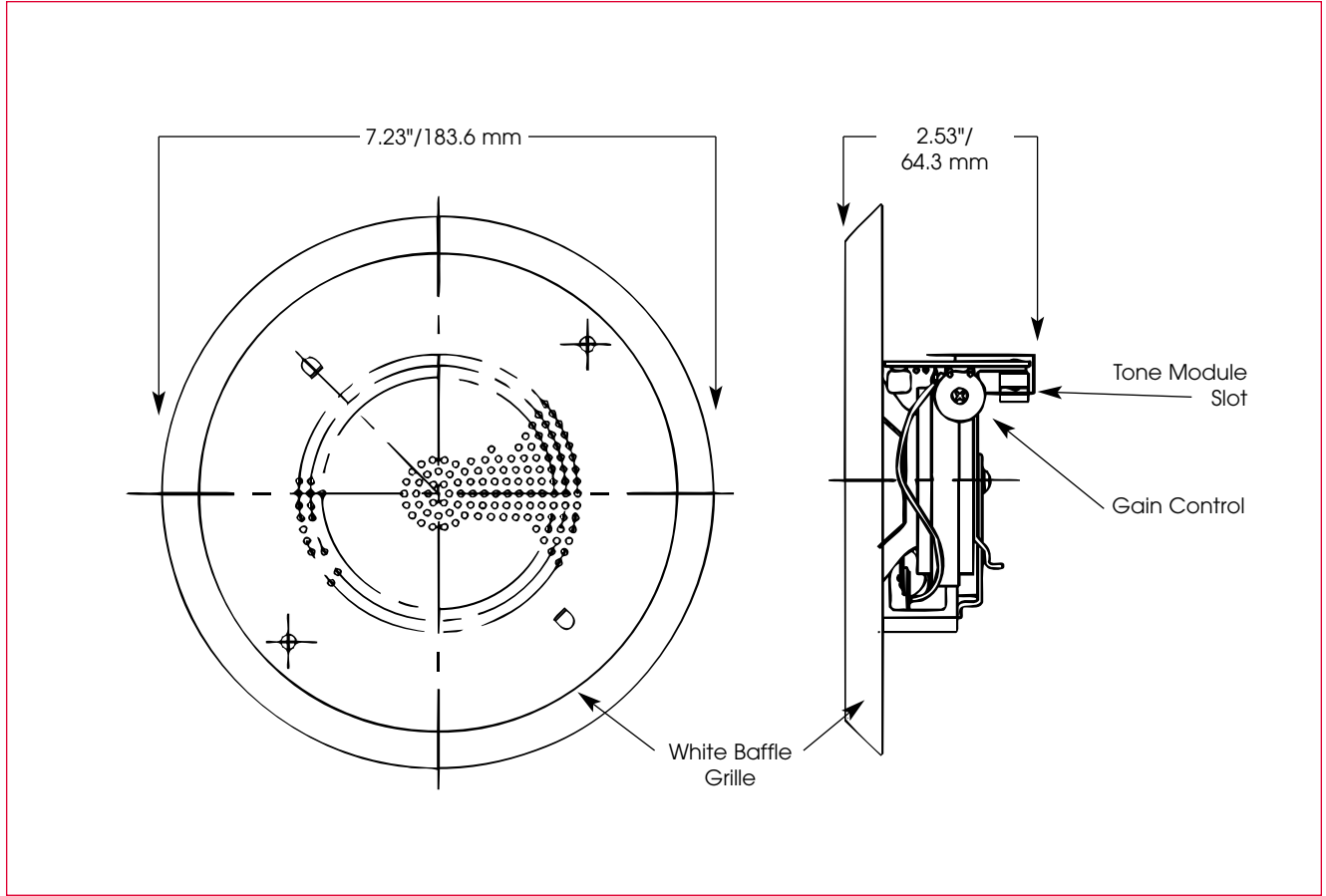

**SPECIFICATIONS**

Operating Temperature:	-31°F to 161°F	-35°C to 72°C
Net Weight:	1.6 lbs.	0.73 kg
Shipping Weight:	2.3 lbs.	1.04 kg
Depth:	2.53"	64.3 mm
Diameter:	7.23"	183.6 mm

**HOW TO ORDER**

- Specify model and voltage
- Specify Tone Module for stand alone operation
  - Universal Tone Module (UTM)
  - Custom Tone Module (TM33)
- Specify Connector Kit for use in systems
  - Connector Kit (300CK)
  - Supervised Connector Kit (300CKS)
  - 25Vrms Connector Kit (AM25CK)
  - 70Vrms Connector Kit (AM70CK)
  - 100Vrms Connector Kit (AM100CK)
- Specify options:
  - Back Box (R4NB)