

# Resonating Horns

## Models 55 and 56



### DESIGNED FOR HIGH AMBIENT NOISE AREAS

- Resonated column of air generates sound
- Model 55 produces 105dB @ 10' (115dB @ 1m)
- Model 56 produces 108dB @ 10' (118dB @ 1m)
- 120VAC Model 55 is UL Listed, CSA Certified for indoor/outdoor applications, Models 55 and 56 are FM Approved
- NEMA 4, IP54 enclosure

The Federal Signal Models 55 and 56 are electric horns that produce sound by means of a diaphragm, which resonates a column of air. Because the output is greater than that of a vibrating horn resonating horns can be used wherever a louder, more powerful signal is required.

Both models feature corrosion-resistant cast aluminum housings with a brass projector. These projectors are designed to match the frequency of the vibrating diaphragm to produce a smooth musical tone. The housings are tapped for 1/2" conduit (swivel bracket included).

Models 55 and 56 are finished in gray enamel and equipped with a straight projector. These weatherproof horns are water- and dust-tight when installed with conduit.

The Model 55 is available with a coiled projector, and the Model 56 is available with a coiled projector and bulkhead mount.

Model 55 is also UL (Underwriters Laboratories) Listed for indoor/outdoor use and CSA (Canadian Standards Association) Certified. Both models are FM Approved. Models 55 and 56 have a duty cycle of five minutes on, five minutes off.

Models 55 and 56 are ideal for both indoor and outdoor use. They require minimum maintenance; their rugged designs seal out corrosive dust and vapors. Both models have sufficient output to penetrate through high ambient noise levels.

Model	Voltage	Operating Current	Decibels @	
			10'	1m
55	24VAC 60Hz	3.0 amps	105	115
55	120VAC 60Hz	0.75 amps	105	115
56	12VDC	7.0 amps	106	116
56	24VDC	3.0 amps	106	116
56	125VDC	0.25 amps	106	116



## RESONATING HORNS (55/56)

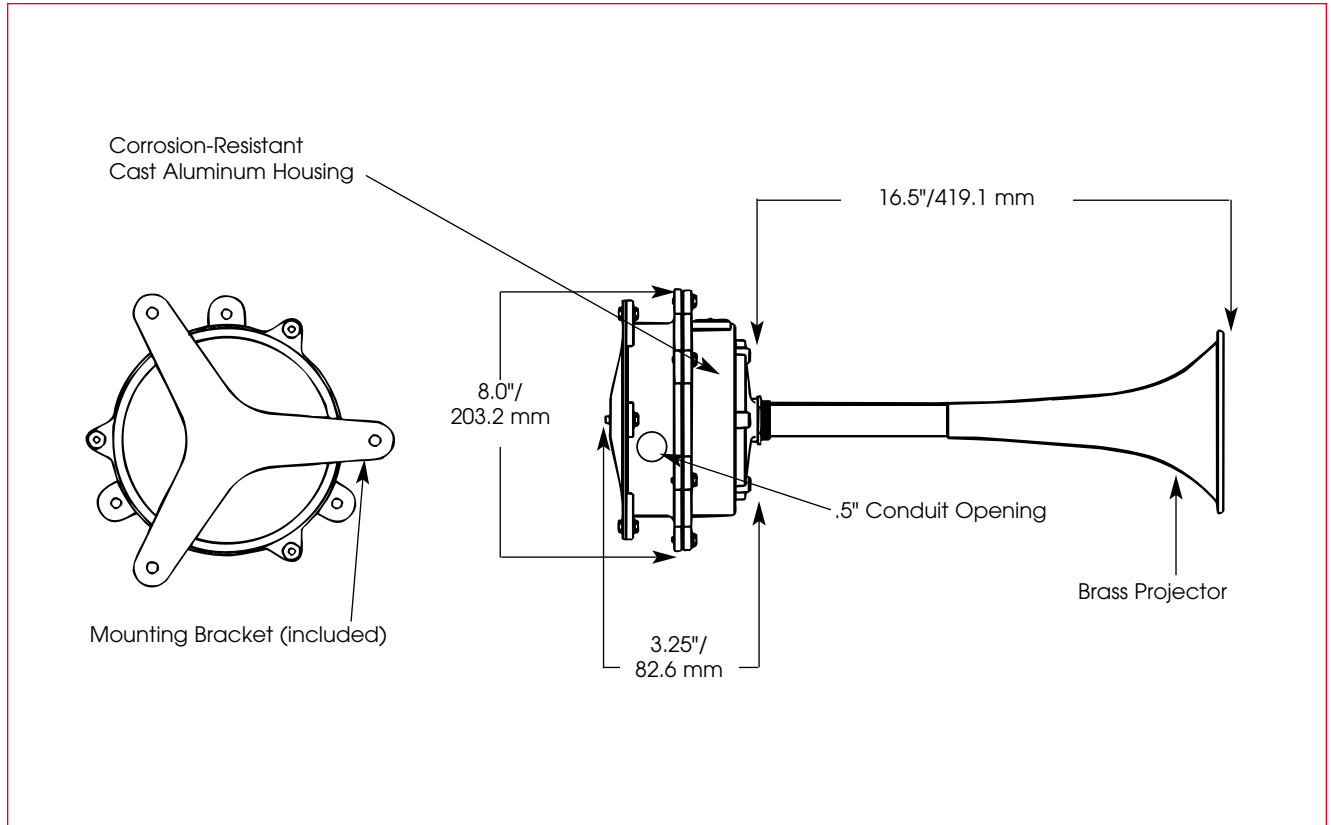

### SPECIFICATIONS

Operating Temperature	-35°F to 150°F	-37°C to 66°C
Net Weight:	5.0 lbs.	2.3 kg
Shipping Weight:	6.2 lbs.	2.8 kg
Height:	8"	203 mm
Width:	8"	203 mm
Length:	19.75"	502 mm
Duty Cycle:	5 minutes ON/5 minutes OFF	

### HOW TO ORDER

- Specify model and voltage
- Specify options from list

### OPTIONS

<i><b>Description</b></i>	<i><b>Part Number</b></i>
Straight Projector	K8283C071-0G
Coiled Projector	K8233C007-0G
Mounting Bracket, Bulk Head	K8233A036
Mounting Bracket Accessory Kit	K8233A046-0G